

DZS3 series high-power electromagnetic power-off brake

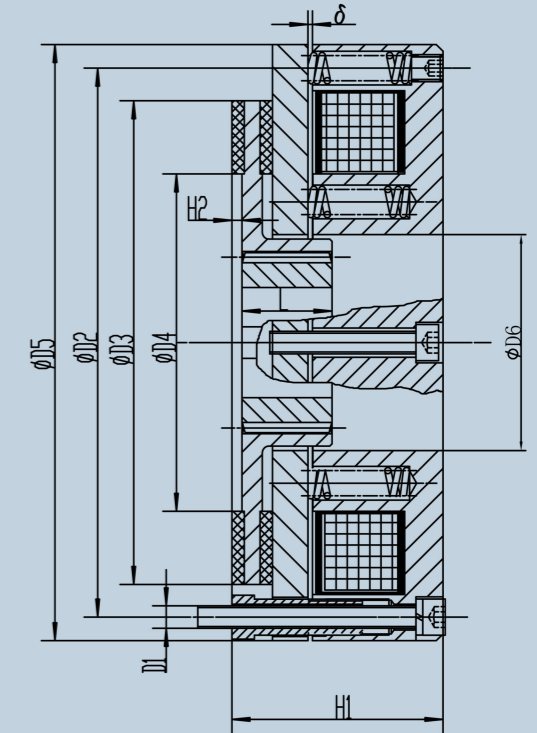

Overall and Installation Dimensions

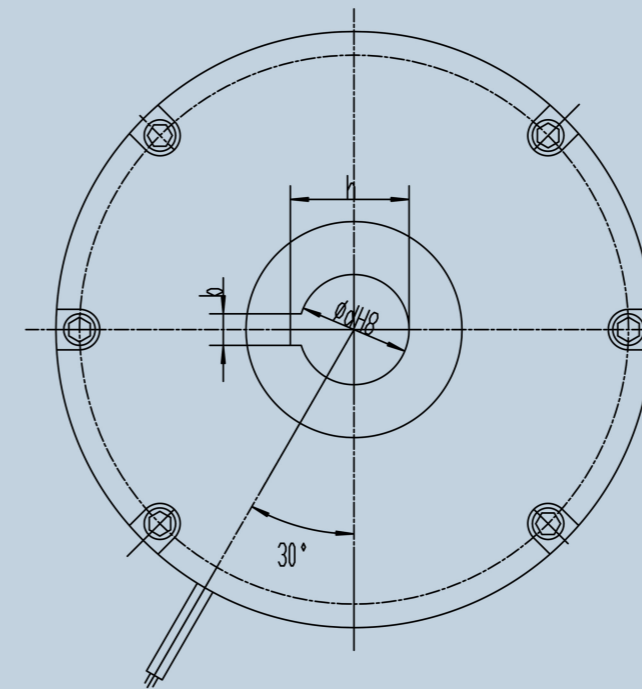

Applications

DZS3 series high-power electromagnetic power-off brake is a friction brake with power-off spring brake. It is mainly matched with Y series motors to form YEJ series electromagnetic braking three-phase asynchronous motors. Widely used in metallurgy, construction, chemical industry, food, machine tools, packaging and other machinery, as well as power failure (risk prevention) braking and other occasions. This kind of brake has the advantages of compact structure, convenient installation, wide adaptability, low noise, high working frequency, sensitive action and reliable braking, etc. It is an ideal automatic actuator.

Main Technical Data

Size	200	300	450	600	850	2000	2500
Motor frame size	180	200	225	250	280	315	355
Rated torque(N.M)	200	300	450	600	850	2000	2500
Rated power 20°C (W)	130	140	160	170	360	360	360
Connection time T1(ms)	252	303	359	385	435	495	495
Disconnection time T2(ms)	210	250	270	285	320	375	375
Normal clearance δ (mm)	0.6	0.8	0.8	0.8	1.0	1.2	1.2
Max.clearance δ_{max} (mm)	1.2	1.5	1.5	1.6	1.8	1.8	1.8
Rated voltage DC(V)	170						
Allowed speed n(rpm)	3000						

Remark:

- 1,normal clearance δ must be met when brake was fixed,if actual clearance is over Max.clearance δ_{max} ,it must be adjusted to normal clearance δ ;
- 2,different voltage can be ordered.

Size	d	b	h	L	D1	D2	D3	D4	D5	D6	H1	H2	δ
DZS3-200	49	14	52.8	40	4*M10	244	215	150	265	96	87.6	4.5	0.6
DZS3-300	59	18	63.4	50	4*M12	280	248	155	310	104	104.8	3.5	0.8
DZS3-450	65	18	69.4	56	4*M12	300	268	165	330	120	109.8	3.5	0.8
DZS3-600	65	18	69.4	56	4*M16	350	305	180	380	128	132.8	4	0.8
DZS3-850	68	18	72.4	62	6*M16	390	350	195	422	150	134	4	1.0
DZS3-2000	80	22	85.4	62	8*M16	550	510	350	580	260	145.2	7.5	1.2
DZS3-2500	80	22	85.4	62	8*M16	550	510	350	580	260	145.2	7.5	1.2

Unit:mm.

Installation

- The surface of friction plate and armature shall be free of oil stain and shall be kept clean;
- Air gap(δ) must be ensured during installation;
- The gear sleeve shall not move axially;
- After installation, the lock nut must be locked on the rear end cover or flange of the motor;
- The installation mode of brake is axial horizontal with air cooling;

Installation Diagram

- 1,motor endshield;
- 2,brake disc;
- 3,hollow bolt;
- 4,armature;
- 5,release handle;
- 6,gear sleeve;
- 7,magnetic yoke;
- 8,fixing screw;
- 9,adjust nut;
- 10,fan;

